

Technical Specifications

TECHNICAL SPECIFICATIONS ninoSAFE Pro Class II					
Size		900	1200	1500	1800
Dimensions					
External dimensions excl support, WxDxH	mm	1003x799x1329	1303x799x1329	1603x799x1329	1907x799x1329
External dimensions incl support, table top at 800 mm, WxDxH	mm	1003x799x2053	1303x799x2053	1603x799x2053	1907x799x2053
Internal dimensions, WxDxH	mm	900x520(625)x700	1200x520(625)x700	1500x520(625)x700	1800x520(625)x700
Front window opening	mm	200 (adjustable 160 - 330)			
Work height, basic support stand	mm	800 or 900 (±25)			
Work height, adjustable support stand	mm	700-1050			
Work height, electrically elevated support stand	mm	750-1050			
Minimum door way	mm	800			
Weight					
Equipment	kg	190	220	250	280
Air velocity					
Vertical flow	m/s	0,28 (adjustable 0,25 - 0,53)			
Inflow	m/s	0.45 (adjustable 0.45 - 0.55)			
Deviation	±%	< 8			
Noise					
Noise level, measured according to EN12469	dB(A)	46	46	47	47
Ventilation					
Down flow rate	m3/h	510	680	840	1010
Exhaust flow rate	m3/h	290	390	480	580
Filter technology					
Main/Exhaust	type	HEPA H14 EN1822, 99,999% at 0,3 µm particle size			
Light					
LED	Lux	0-2000, dimmable			
Electrical data					
Voltage frequency	V/Hz	220-240/50-60 or 110-120/50-60			
Power consumption, from	W	90	100	130	140

Our models are built and tested according to national and international standards, including EN 12469, NSF/ANSI 49, EN61010-1

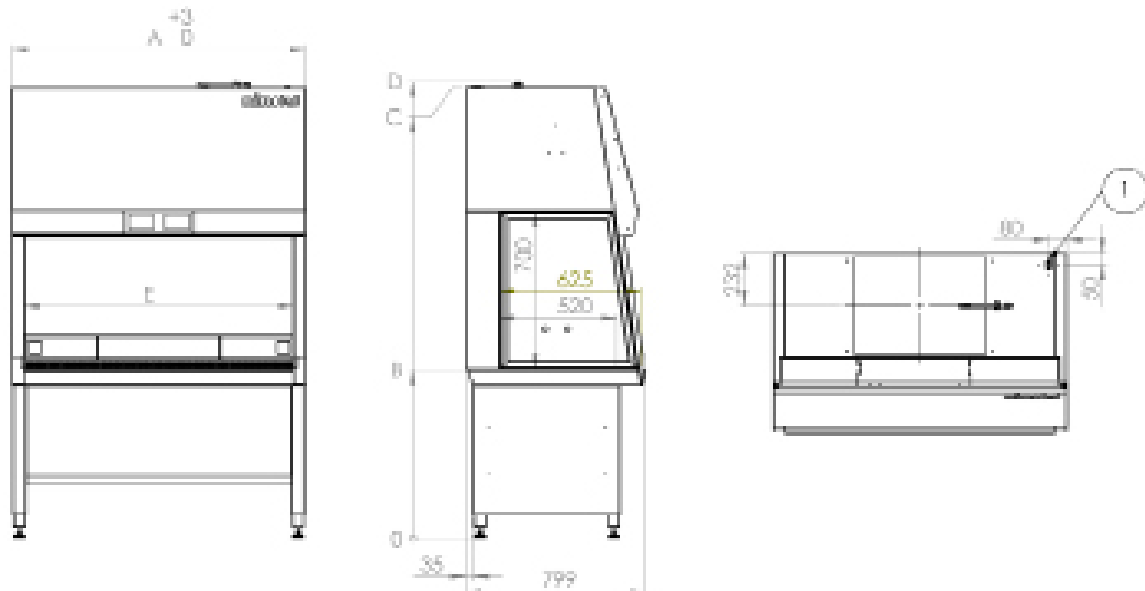

ninoSAFE PRO Class II Specifications						
Cabinet	A - Length	B - Work height	C - Top cabinet	D - Highest point	E - Work opening	W - Weight
nino SAFE 900	1003 mm	700-1050 mm	1953-2303 mm	1978-2328 mm	900 mm	190 Kilo
nino SAFE 1200	1303 mm	700-1050 mm	1953-2303 mm	1978-2328 mm	1200 mm	220 kilo
nino SAFE 1500	1603 mm	700-1050 mm	1953-2303 mm	1978-2328 mm	1500 mm	250 kilo
nino SAFE 1800	1907 mm	700-1050 mm	1953-2303 mm	1978-2328 mm	1804 mm	280 kilo

Notes	
POS.	Description
1	Power Supply Point